

MLP

Gorzów Wielkopolski

Modern complex offering
a mix of warehouse
and office space for lease



MLP
Gorzów
Wielkopolski
Mosiężna 24
66-400 Gorzów
Wielkopolski, Poland



Suitable for:
Land plot area:
Total area:
Location:

assembly, logistics, light industry, warehousing
11.7 ha
56,673 sqm
9 km from the centre of Gorzów Wielkopolski

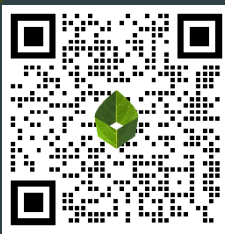

MLP
GROUP

MLP Gorzów Wielkopolski

The logistics and warehousing complex has been designed to meet the BREEAM certification requirements, which will substantially reduce tenant service costs. In line with the Company's strategy, MLP Gorzów Wielkopolski will feature a range of sustainable solutions. It will be focused primarily on tenants operating in the e-commerce, logistics, distribution and light industrial manufacturing sectors.

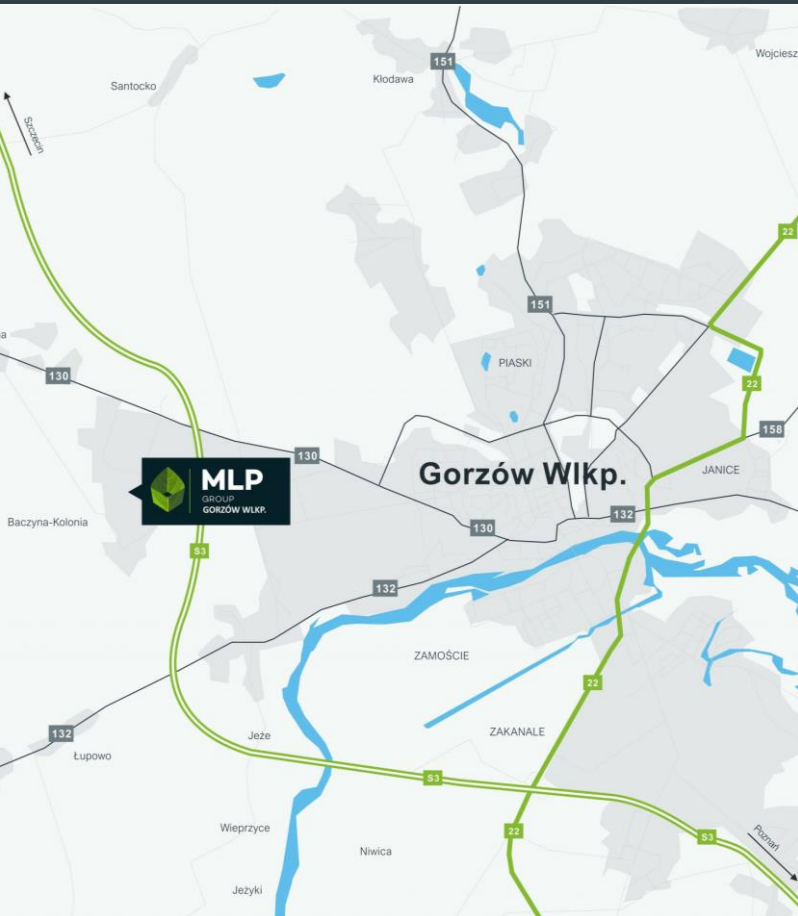

Technical specification:

- Class A buildings
- Column grid: 12 m x 22.5 m
- Floor load-bearing capacity – 6T/m²
- 10 m net height
- Skylights and smoke flaps
- ESFR sprinkler system
- Gas heating
- LED lighting
- Office and staff amenity space at a client's request
- 24h security services

Distances:

- 1 km from expressway S3
- 9 km from the city center of Gorzów Wielkopolski
- 53 km from the German border

Public transport services:

Given its close proximity to the city centre, the park enjoys good access to municipal transport services.

Contact details:

MLP Group S.A.
ul. 3 Maja 8
05-800 Pruszków
leasing@mlpgroup.com
www.mlpgroup.com

Leasing Manager
Ewa Ciołek
+48 501 839 609
e.ciolek@mlpgroup.com

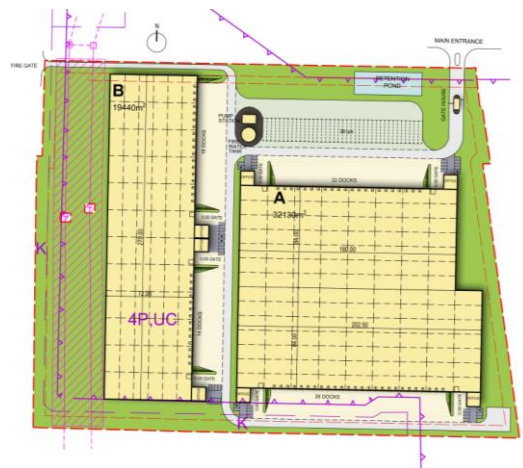

MLP
GROUP